

AMENSOLAR

AW5120 LifePo4 Battery



- 51.2V/5.12KWh
- Being paralleled 16 sets
- UL1973 certificate
- 2U Wall Mounted



Wall-hanging

the module can be mounted on the wall with the characteristics of easy maintenance, flexibility and versatility



LFP Prismatic Cell

current interrupt Device (CID) helps pressure relief and ensures safe and detect controllable aluminum shells is welded to ensure sealing



51.2V low-voltage

support 16 sets parallel connection



BMS

Real-time control and accurate monitor in single cell voltage,current and temperature, ensure battery safety

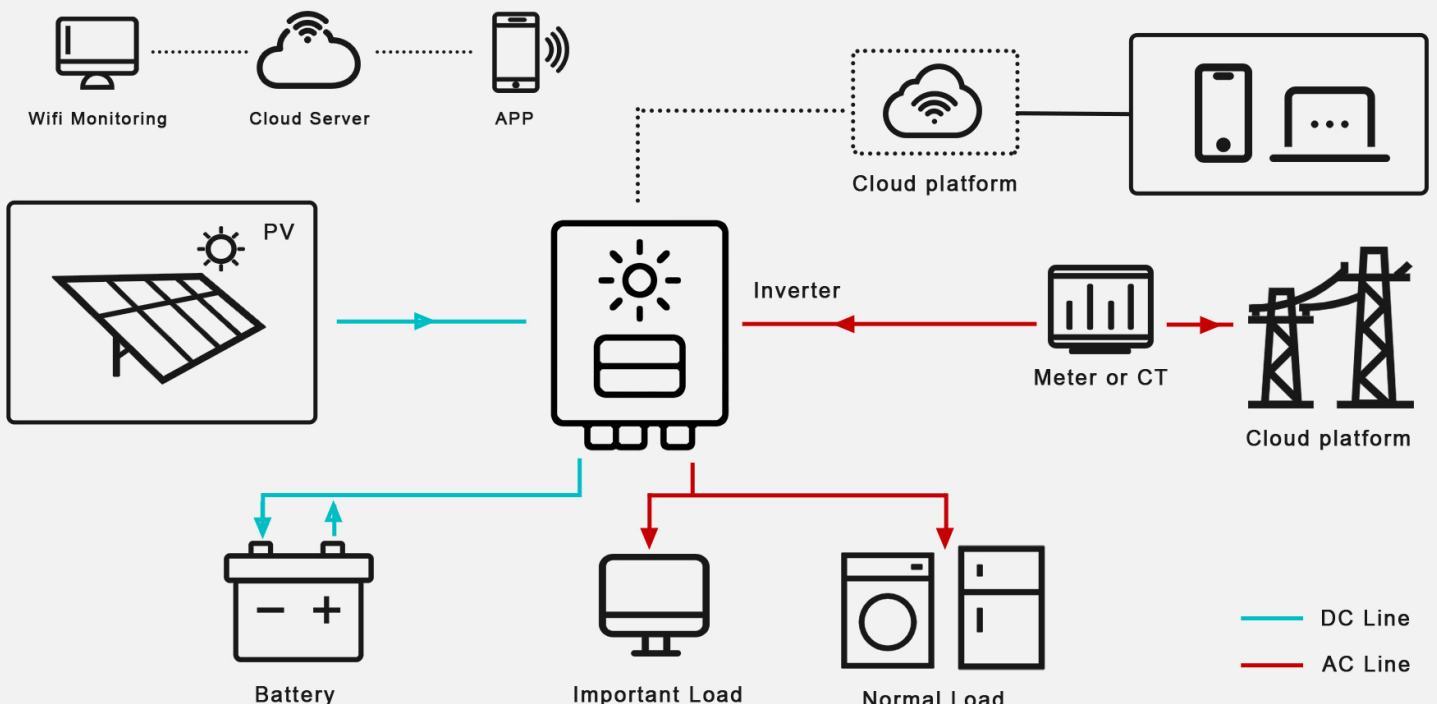

Battery Name	AW5120
Certificate Model	YNBB16S100KX-L
Battery Type	LifePo4
Mount Type	Wall Mounted
Nominal Voltage (V)	51.2
Capacity(Ah)	100
Nominal Energy (KWh)	5.12
Operating Voltage(V)	44.8~57.6
Max Charge Current(A)	100
charging Current(A)	50
Max Discharge Current(A)	100
discharging current(A)	50
charging Temperature	0C~+55C
Discharging Temperature	-20C~+55C
Relative Humidity	5% - 95%
Dimension(L*W*H mm)	540*704*94
Weight(KG)	45±0.5
Communication	CAN, RS485
Enclosure Protection Rating	IP20
Cooling Type	Natural Cooling
Cycles Life	≥6000
Recommend DOD	90%
Design Life	20+ Years (25°C @77°F)
Safety Standard	UL1973/CE/IEC62619/UN38.3
Max. Pieces of Parallel	16